The Valley Club

Sun Valley, Idaho

McLaughlin & Associates

RCI Inc.

Brief: Design Sun Valley's first private golf clubhouse to look as if it's always been there

Strategy: Use rustic finishes and Arts & Crafts styling to recreate the character of an old and much-used mountain lodge

Chandeliers, beams, and an airy sculptured steel panel lend an intimate, human scale to the high-ceilinged dining room.

Carpet: Bentley; lighting: Halo; doors: Gammon Bros.; hardware: Rocky Mountain Sash & Door; windows/glass: Eagle Windows; custom chairs: Caracol with Brayton leather and Robert Allen fabric; paint: Cordeau; custom tables: Madsen Design; custom sconces, chandelier: Triumph Metalwork; fish sculpture: Francien Valk, Bradley Horn (fabricator).

LONG FAVORED BY ski enthusiasts, Sun Valley now has its first private golf club, anchoring a 600-acre residential development in the foothills of the Pioneer Mountains. Nestled into the landscape like an old hunting lodge, The Valley Club's 12,000-square-foot clubhouse and restaurant takes its cue from the turn-of-the-century Arts & Crafts style. It is the work of architects McLaughlin & Associates of Sun Valley, with interiors by Seattle-based RCI Inc. "It's meant to be a gathering space for good friends and family, with the comfort and warmth of a favorite easy chair," says architect Jim McLaughlin.

The first welcoming gesture is a massive 35-by-12-foot stone fireplace with twin hearths, that separates the foyer from the dining room. The clubhouse's interior beams (some are 100 feet long), floors, cabinetry, and trim are made of timber salvaged from an old Idaho sawmill; stone used for the fireplace and interior columns came from a local quarry. Rose Capestany,

principal of RCI, designed oversized sofas and chairs to create comfortable seating areas in front of each hearth. "We wanted the club to feel like an extension of the members' own homes," explains Capestany, "so the furnishings and details had to stand up to the large-scale architectural features."

The focal point of the clubhouse (which also houses locker rooms, a pro shop, and administrative offices) is a 2,500-square-foot, exposed post-and-beam dining room seating 96. Its soaring 35-foot cathedral ceiling is brought into scale by pendant drum-shaped chandeliers of blackened and rusted steel with stretched rawhide bottom panels, designed by Capestany to maintain the architectural character of the space. The chandeliers frame the tops of windows, which are more than 16 feet high to take advantage of the mountain views. Colors and artwork relate to the natural environment, with subtle references to Native

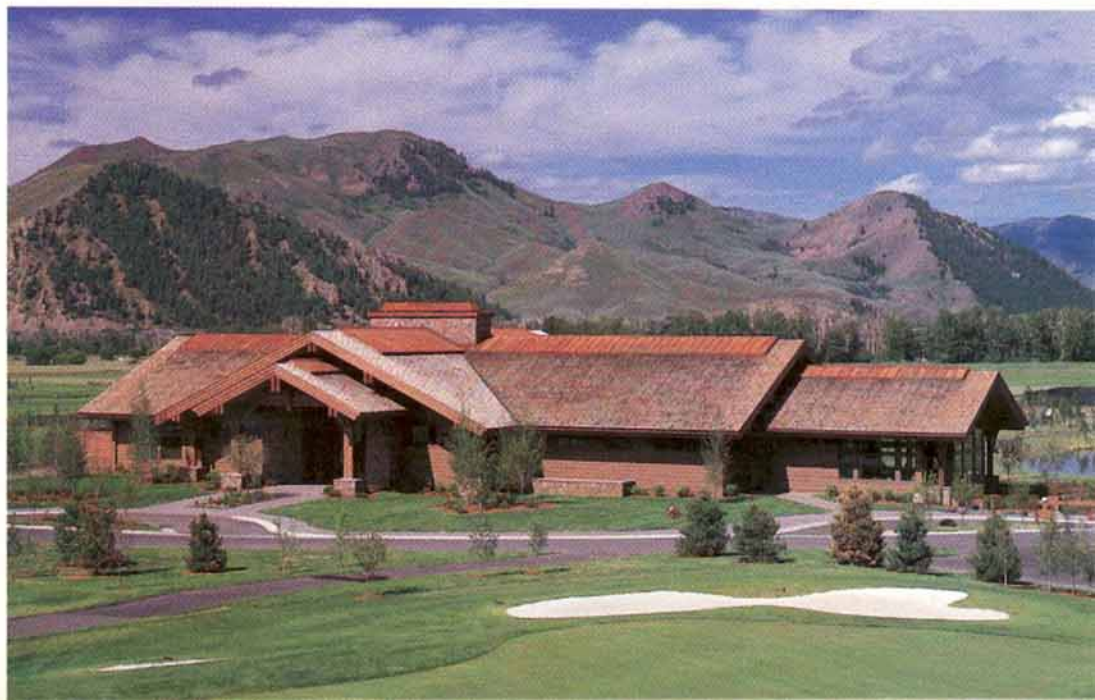



American motifs. Green, gold, blue, red, and brown tones in the custom upholstery and carpet capture the changing palette of the seasons, while Francien Valk's murals of deer and buffalo pay tribute to indigenous wildlife. A multi-layered steel sculpture of salmon floats between two columns, an animated detail that divides the expansive dining room into visually intimate areas without actually enclosing the spaces. The dining room and 30-seat bar are fitted with spike-proof carpet, so members don't have to change their golf shoes before entering.

● *Kristen Richards*

A private dining room features an unusual 19th-century cabinet.

Carpet: Bentley; lighting: Halo; doors: Gammon Bros.; hardware: Rocky Mountain Sash & Door; windows/glass: Eagle

Windows; custom chairs: Caracol with Pindler & Pindler fabric; table: Antique Designs; paint: Cordeau; cabinet: Pelayo Antiques; accessories: Lone Star, Designer Choice.

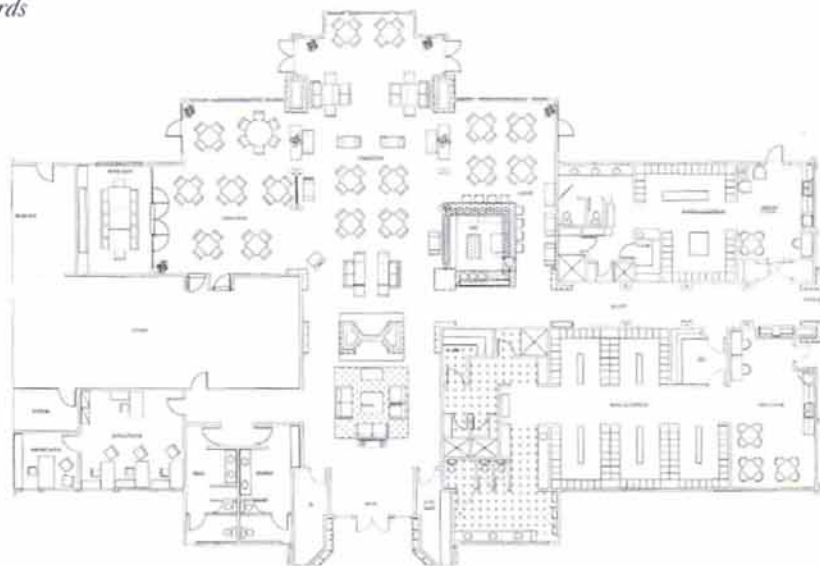

McLaughlin & Associates

a full service architectural and planning firm licensed in ten states, was founded in Sun Valley in 1975, and now has a staff of eight. Projects include residential, commercial, mixed-use, retail, historic restoration and adaptive reuse design, as well as housing, healthcare, and resort planning.

RCI Inc.

Seattle-based RCI is a 13-year-old interior design firm of six that specializes in hospitality, residential, and multi-family recreation projects. Recent projects include luxury resorts and homes in the Caribbean, Hawaii, New York, and Palm Springs. The firm also works extensively on upscale homes, condominiums, and apartment complexes in the Pacific Northwest.

Project credits

Client: Valley Ranch, Inc.
 Architecture: McLaughlin & Associates
 Design team: Jim McLaughlin, Bernie Johnson
 Interior Design: RCI Inc.
 Design team: Rose Capestany, Tom Miller
 General contractor: Storey Construction
 Structural engineer: Bouisse & Associates
 Landscape design: Clemens & Associates
 Kitchen design: S.J. Russo
 Photography: Chris Eden Associates



The rustic foyer offers a comfortable seating area in front of a stone fireplace separating the entrance from the dining room.

Sofas: Walenta's Upholstery with Momentum leather; lounge chairs: Beverly with Pindler & Pindler fabric; throw pillows: MB Designs with Pindler & Pindler fabric and Brunschwig & Fils fringe; custom rug: Hancock Carpets; custom coffee table: Caracol; custom chandelier: Triumph Metalwork; fireplace tools, door: Bradley Horn; accessories: Charles Stuhlberg, Legacy Antiques; wreath: Silk Warehouse.